

Other ElectroShade® Components & Optional Accessories

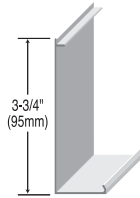

FASCIA FOR ELECTRO/3 & ELECTRO/3 DOUBLESHADE #20 BRACKETS
REGULAR ROLL
MFAA RG15 AL __

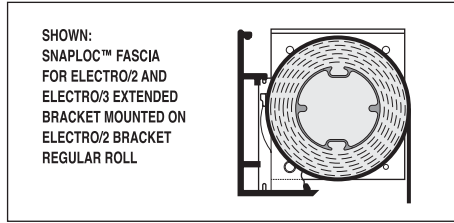
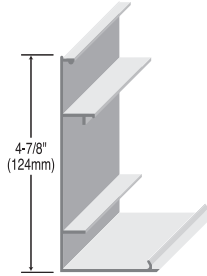

FASCIA FOR ELECTRO/2 & ELECTRO/3 EXTENDED BRACKETS
REGULAR ROLL
UFAA 4715 AL __

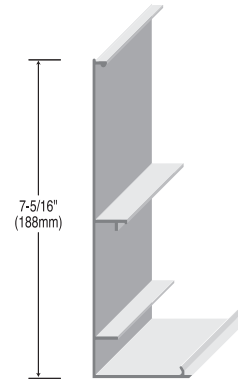

FASCIA FOR ELECTRO/2 EXTENDED, ELECTRO/2 DOUBLESHADE #17 & ELECTRO/3 DOUBLESHADE #21 BRACKETS
REGULAR ROLL
UFAA 7321 AL __

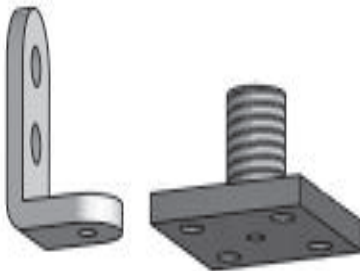

Guide Cables
are used when shades are sloped or the width to height ratio (1:6) needs assistance in keeping the shade tracking correctly.

Tension Idler Cable Kit w/ 20 ft. Cable
EGCA 4112 AS NP

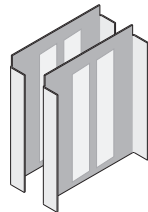

ELECTRO/3 FASCIA END CAPS (PAIRS)
MFA 3036 AL __

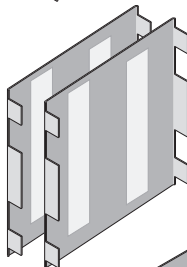

ELECTRO/2 & ELECTRO/3 EXTENDED FASCIA END CAPS (PAIRS)
MFA 3346 AL __

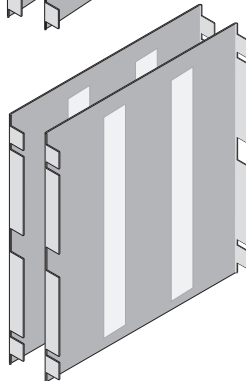

ELECTRO/2 EXTENDED, ELECTRO/2 DOUBLESHADE #17 & ELECTRO/3 DOUBLESHADE #21 FASCIA END CAPS (PAIRS)
MFA 3070 AL

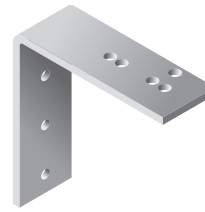

SINGLE WALL-MOUNT ANGLE FOR ELECTRO/1, ELECTRO/2 & ELECTRO/3
4" x 4" x 1-1/4"
(102 x 102 x 32 mm)
EWBX 4040 ST ZP
Plated

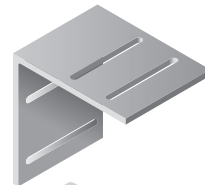

DOUBLE WALL-MOUNT ANGLE FOR ELECTRO/1, ELECTRO/2 & ELECTRO/3
4" x 4" x 3"
(102 x 102 x 76 mm)
EWBX 4145 ST ZP
Plated



SINGLE WALL-MOUNT ANGLE FOR ELECTRO/3, ELECTRO/3 POCKET & ELECTRO/3 EXTENDED
4" x 4" x 1-1/4"
(102 x 102 x 32 mm)
EWBX 4040 ST ZP
Plated



SINGLE WALL-MOUNT ANGLE FOR ELECTRO/1 EXTENDED, ELECTRO/2 EXTENDED, ELECTRO/1 DOUBLE SHADE #13 & ELECTRO/2 DOUBLE SHADE #17
5" x 5" x 1-1/4"
(127 x 127 x 32 mm)
UWBX 5050 ST PL

MechoShade Systems, Inc.
42-03 35th Street, Long Island City, NY 11101
Telephone: 718-729-2020
Fax: 718-729-2941 / 800-899-8081

E-mail: info@mechoshade.com
Internet Web Site: <http://www.mechoshade.com>

3.21
MS2200 - 01/01/08



Batten and Seam Specifications

Battens vs. Seams: MechoShade Systems, Inc. is one of the only, if not the only, shade manufacturer to use a batten joint vs. a seam joint. This type of construction costs more, but is highly effective in ensuring that certain types of shade bands hang and track straight. See page 3.23 for an illustration of the Batten vs. Seam joint.

Woven ScreenCloth: All woven ScreenCloth, regardless if their core yarns are polyester or fiberglass, will stretch under their hanging weight due to "Woven Fabric Mechanical Extensibility" or "The Hour Glass Effect". In order to assure the proper tracking and rolling of the shadeband, and avoid the "Hour Glass Effect", battens are included by MechoShade as a standard detail when the width-to-height (W:H) ratio exceeds 1:4. Railroaded, multi-width shade bands will receive a 2" (51mm) batten joint. Battens may be specified for shade bands that otherwise do not need them to align with shade bands that do require battens, at additional cost. Battens will be positioned on the shade band, per the chart below, or at customer specified positions, subject to approval of MechoShade Systems, Inc., and may be at additional cost.

Standard Batten Placement for Non-Railroaded (Standard) ElectroShades:

- Batten placement for non-railroaded shades shall be the minimum required to meet the 1:4 ratio of width to height.
- Battens shall be equally spaced within the shadeband opening height. For example one batten at the mid point, or two battens at 1/3 points, or three battens at 1/4 points.
- Batten placement for blackout shades with side channels shall not exceed 4'-0" (122cm) o.c. and must be specified.

Standard Batten Placement for Railroaded (RR) ElectroShades*					
Roll Widths	63" (160cm) RR*	72" (183cm) RR*	96" (244cm) RR*	126" (366cm) RR*	
SHADE HEIGHTS	Requires 1 width Railroaded* no seam				
	Requires 1-1/2 widths Railroaded*, +1 seam				
	Requires 2 widths Railroaded*, +1 seam				
	Requires 2-1/2 widths Railroaded*, +2 seam				
	Requires 3 widths Railroaded*, +2 seams				

* All shades are measured from the bottom of the shade up to the center of the Batten joint. Railroad (RR) Shadecloth is turned width to height. All heights shown above are Opening Heights only and are based on a 2-1/2" diameter tube. Opening Heights do not include wrap. Cut panel sizes, including wrap, hempocket and additional fabric for sealing battens and seams, are added to the opening height dimension

Width-to-Height (W:H) Ratio Guidelines and Edge-Clearance Specifications (fabric used normally or railroaded)

- Shadebands up to 1:3 W:H ratio**, require the standard edge-clearance deduction except for 30" (76cm) wide shadebands.
- 1:3 to 1:4 W:H ratios**, increase the hardware edge-clearance 1/16" (1.6mm) each side to 1/8" (3.2mm) additional deduction.
- 1:4 to 1:5 W:H ratios**, increase the hardware edge-clearance 1/8" (3.2mm) each side to 1/4" (6.4mm) additional deduction. Battens or optional guide cables are required.
- 1:5 to 1:6 W:H ratios**, increase the hardware edge-clearance 1/4" (6.4mm) each side to 1/2" (12.8mm) additional deduction. Battens or optional guide cables are required.
- Over 1:6 W:H ratios**, increase the hardware edge-clearance 5/16" (8mm) each side to 5/8" (16mm) additional deduction. Battens & guide cables are required.
- Railroaded multi-width shades** with horizontal joints shall have seam joints.
- Environmental conditions may require** additional use of guide cables and/or battens and increased edge clearance.

MechoShade Systems, Inc.
42-03 35th Street, Long Island City, NY 11101
Telephone: 718-729-2020
Fax: 718-729-2941 / 800-899-8081

E-mail: info@mechoshade.com
Internet Web Site: www.mechoshade.com

604/2
REVISION
3.22
MS2200 - 01/01/08



ShadeWords

MechoShade®
ElectroShade®

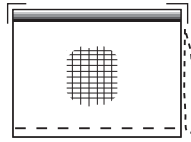

MechoShade®

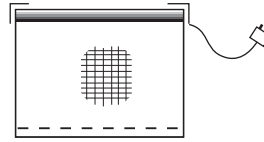

ElectroShade®

SingleBand™
MultiBand™
Regular- & Reverse-Roll

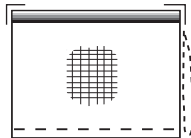

SingleBand

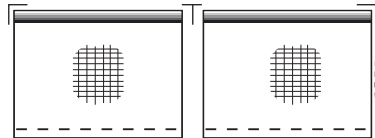

Multiband™
(2 or more shadebands on one operator
MechoShades or ElectroShades)

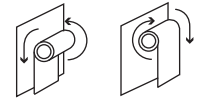

Regular
Roll
(unwinds
towards
glass)

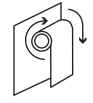

Reverse
Roll
(unwinds
away from
glass)

SingleShade™
DualShade®
DoubleShade™

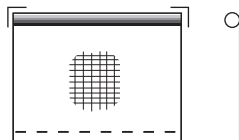

SingleShade™
(Standard)

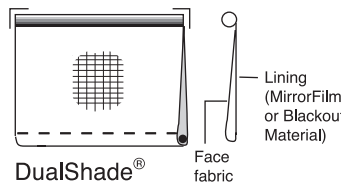

DualShade®

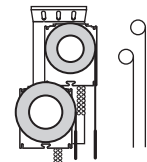

DoubleShade™
(2 on 1 bracket)

Non-Railroded ShadeCloth
(NRR) (Standard)
Railroded ShadeCloth (RR)
(Landscape)

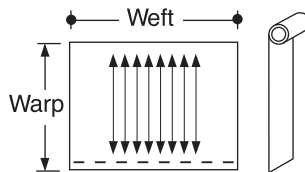

Non-Railroded ShadeCloth
(ShadeCloth used normally)

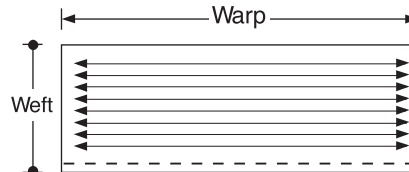

Railroded ShadeCloth
(ShadeCloth used width for height)

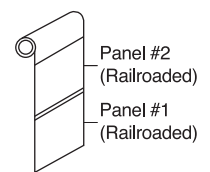

Panel #2
(Railroded)
Panel #1
(Railroded)

SingleWidth™
MultiWidth™

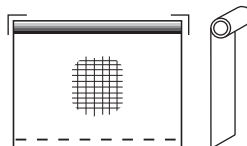

SingleWidth™
(No seams)

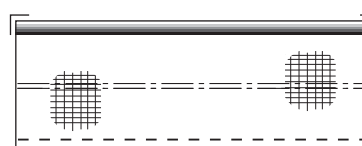

MultiWidth™
(A shadeband with 2 or more widths joined
with a joint batten)

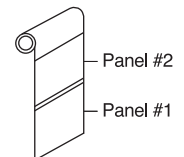

(Railroded or
Non-Railroded)

Seam joint (Special)
Batten joint (Standard)

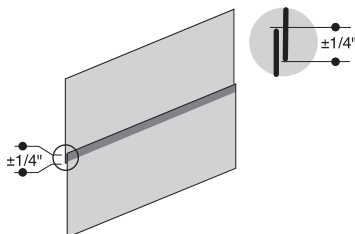

Seam joint
For Fabric Wrap or as Specified.

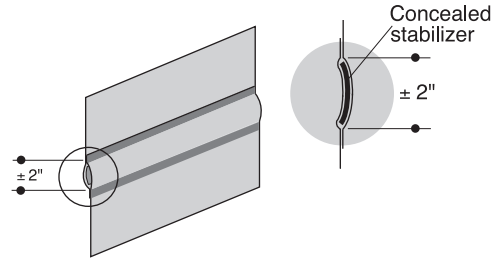

Batten joint
Standard Joint

MechoShade Systems, Inc.
42-03 35th Street, Long Island City, NY 11101
Telephone: 718-729-2020
Fax: 718-729-2941 / 800-899-8081

E-mail: info@mechoshade.com
Internet Web Site: <http://www.mechoshade.com>

3.23
MS2200-01/01/08



Electro[®]/1, 2 & 3 Hardware Features and Specifications

The ElectroShade[®] system is designed, developed and fabricated to be a totally integrated unit and is furnished by the manufacturer, MechoShade Systems, Inc., with a warranty which provides that all components (motor, shade cloth, electrical controls and override circuits) have been designed and tested as a compatible integrated system.

The basic control configuration is one or two ElectroShades controlled from a single line voltage D.P.D.T. switch. For control of three or more motors from a single switch, or for mid window shade alignment at the touch of a button, a multi-motor controller such as the MLC[™], I-CON, IQ/MLC[™] or IMCS[™]/2 is required. (See Controls Section.)

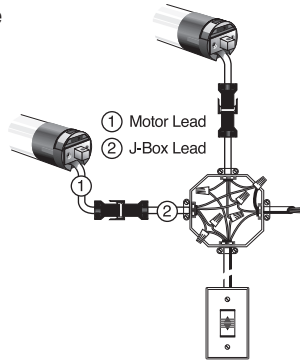

1.0 ElectroShade Hardware

1.1 Mounting Brackets: The drive assembly, idle-end assembly, and center support systems are attached to an 1/8 in. (3mm) steel mounting bracket.

1.2 Shade Roller: Extruded aluminum tube, 6063-T6 alloy, 1-3/4 in. (44 mm), 2-1/2 in. (63 mm), 3-1/2 in. (90 mm) or 4-1/2 in. (114 mm) OD (as required) with internal keyway to receive tubular motor. The tube is extruded with two fabric-mounting channels designed to support the shade bands via the SnapLoc[®] spline (see below).

1.3 SnapLoc[®] Mounting Spline: Extruded vinyl with asymmetrical locking channels and embossed fabric guide for use with 1-3/4 in. (44 mm), 2-1/2 in. (63 mm), 3-1/2 in. (90 mm) or 4-1/2 in. (114 mm) OD tube. Spline has sufficient capacity to support the shade and additional hem weights without disengaging from the tube or without extra wraps of fabric on the tube. SnapLoc Spline shade band assembly may be installed or removed from the shade tube, or tube/motor assembly, without disassembling or removal from the mounting brackets.

1.4 End Brackets: Consist of 1/8 in. (3 mm) thick sheet steel. Wall, jamb or ceiling mounted as required and permanently installed.

1.5 Center Support Brackets: Supplied to allow multibanding. Ceiling or wall mounted. Center support brackets shall accept continuous lengths of fascia, which will span two or more ElectroShade bands up to maximum length of 15 feet (457cm) per section.

1.6 Hembar Weights: Mill-finished aluminum bars in single lengths as appropriate for the size shade, concealed in a fabric hem pocket.

1.7 Exposed hembars in painted and baked PPG finishes with key way for shades.

1.8 DualShade[®] System: The patented DualShade system, by MechoShade Systems, Inc., for installing both a ThermoVeil[®] sun screen together with either a room darkening shade cloth or MirroFilm[™] attached to the same roller tube by means of the SnapLoc spline. The shade cloth and film shall be separated by 1/2 in. (13 mm) of insulating air space.

1.9 Optional SnapLoc[®] Fascia: SnapLoc[®] fascia shall be provided for standard and extended height brackets and center support brackets. Each bracket assembly permits the fascia to extend past the brackets, creating wall-to-wall fascia, with the brackets mounted inboard from the end of the fascia. SnapLoc fascia can be installed as a single unit over two or more shade band assemblies without exposed joints in lengths up to 15 ft. (457cm). SnapLoc fascia snaps on to the brackets without the use of glue, magnetic strips or any exposed fastening.

The fascia is made of extruded aluminum (hardness/alloy 6063T5) with an average thickness of .062 in. (1.6mm). The fascia is finished in PPG Duracon[™] baked enamel in six standard colors plus clear aluminum.

1.10 DoubleShade[®] Mounting Brackets: A master mounting bracket assembly for drive-end, idle-end and center supports to facilitate installation of two shades, front-to-back or top and bottom, with precise alignment and minimum installation labor. DoubleShade[®] brackets have all the same features of the standard ElectroShade bracket, plus allow both sun screen and blackout shades on a single bracket. DoubleShade's compact size allows two shades to fit in a smaller room projection than two individually installed shades on the same window.

Continued 

MechoShade Systems, Inc.
42-03 35th Street, Long Island City, NY 11101
Telephone: 718-729-2020
Fax: 718-729-2941 / 800-899-8081

E-mail: info@mechoshade.com
Internet Web Site: <http://www.mechoshade.com>

3.24
MS2200 - 01/01/08



Electro[®]/1, 2 & 3 Hardware Features and Specifications

2.0 ElectroShade[®] Motor System

2.1 Limit Switches: Internal limit switches are adjusted by two external push button, thumb screws or electronically set to allow exact setting of travel in both the raised and lowered positions. Micro switches provide circuit braking at the end of the run. The limit switch setting cannot be disturbed by the action of the roller tube.

2.1.1 Intelligent Motors with Busline Control may have either manual, push-button or electronic limit switch adjustment.

2.2 Brake: A solenoid activated disc brake mechanism stops and holds in any position. The brake automatically disengages when the motor is operating.

2.3 Motor: An asynchronous (non-synchronous) motor with built-in reversible capacitor start-and-run is made to be operated with 95 to 125 VAC at 60hz. (207-253), single phase, temperature Class-A (maximum temperature rating of 140 C.), thermally protected, totally enclosed, maintenance free with locking disconnect plug assembly furnished with each operator.

2.4 Gear Box: Three or more levels of satellite gears are provided for load distribution (planetary gears) and machined from close tolerance tempered steel or molded plastic. The speed varies according to model from 10 r.p.m. to 64 r.p.m.

2.5 Installation: A single pin locks the drive end of the motor to the tube. A notched section of the tube turns the ring, which counts the turns and activates the limit switch. To interchange motors, the pin is pressed out of the tube and the motor slides out.

2.6 Sizes: The motors are available in torques of 35-435 in. lbs. (lifting capacity), 10-64 r.p.m. speed to meet specified requirements and shall not exceed 60 mm in diameter as 115 VAC (230VAC) motors.

2.7 Connectivity: Motors are available with either a one foot motor lead with a male Disconnect Plug (power plug). The Disconnect Plug end can be plugged into a compatible Plug-In Receptacle or a Junction Box lead with a female Disconnect Plug.

2.8 Warranty: The manufacturer provides warranty that the motor is free of manufacturing defects for five (5) years from the date of installation. This warranty is void if the products have been improperly installed, wired or subjected to improper care. Warranty void if controlled by control systems not previously approved by MechoShade Systems, Inc.

3.0 Shade Cloth, Films and Laminates

(See Section 5 for specifications of ThermoVeil[®], EuroVeil[®] and DualShades[®].)

